

Float on left

Type CG36



File No. E12158  
excludes NEMA 7 & 9 products  
(9038AR, CR, and DR)



File LR25490  
excludes NEMA 7 & 9 products  
(9038AR, CR, and DR)

## Type C, Closed Tank, with Bushing

Flange mounted with bushing for control of liquid level within a closed tank. Build up the switch to meet your requirements from the basic switch, rod kit, and float kit groups below.

Type C switches are attached to the tank by means of a 2-1/2 inch screw-in connection. An external pointer indicates the float position within the tank when the unit is mounted. Switches come complete with screw-in connector, stainless steel float and rod.

**Table 22.74: Class 9038 Type C**

Float Position Viewed from Front of Switch Facing Indicator Scale	R in. (mm)	Approx. Water Level Change		NEMA Type 1		NEMA Type 4		NEMA Type 7, 9	
		Min. (in.)	Max. (in.)	Type	\$ Price	Type	\$ Price	Type	\$ Price
Right	7 (178)	6.5 (165)	13 (330)						
Left	7 (178)	6.5 (165)	13 (330)						
Right	4.25 (108)	4 (102)	7.75 (197)						
Left	4.25 (108)	4 (102)	7.75 (197)						
Right	5 (127)	4.75 (121)	9.25 (235)	CG35	—	—	—	—	—
Left	5 (127)	4.75 (121)	9.25 (235)						

**Table 22.75: Type C Float Travel Adjustments**

R in. (mm)	A in. (mm)		B in. (mm)		C in. (mm)		D in. (mm)		F in. (mm)	
	Min.	Max.	Min.	Max.	Min.	Max.	Min.	Max.	Min.	Max.
5 (127)	2.25 (57)	3.75 (95)	4 (102)	5.25 (133)	2.75 (70)	3 (76)	4 (102)	5.25 (133)	8 (203)	10.5 (267)

▲ CG35, ■

**Figure 22.21: Travel Dimensions**

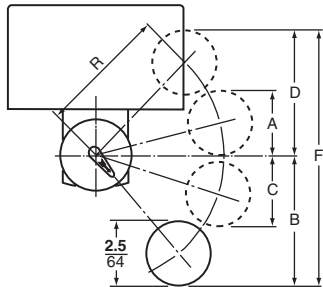

**Figure 22.22: Type CG Dimensions**

