

UTD450 UTD600

Universal Style Quick-Change Trap Module

Thermodynamic Steam Trap Module (mounts to UC450 Universal Connectors)

Model (Side Mount Style)	UTD450LSM UTD450SM	UTD600LSM
Connections	Fits UC450 Series Universal Connectors	
Body Material	Stainless Steel	Stainless Steel
PMO Max. Operating Pressure	450 PSIG	600 PSIG
TMO Max. Operating Temperature	750°F	750°F
PMA Max. Allowable Pressure	720 PSIG @ 100°F	720 PSIG @ 100°F
TMA Max. Allowable Temperature	800°F @ 400 PSIG	800°F @ 600 PSIG



**UTD450
&
UTD600**
**Thermodynamic
Steam Trap Module**
(Side Mount Style)
For vertical or horizontal
piping installations.

Steam trap modules can be used with other manufacturers' Universal Connectors.

Typical Applications

DRIP, TRACER: Designed for drip applications for the draining of condensate from steam mains and other steam supply lines as well as for tracing applications. The **UTD450 & UTD600** Steam Trap Modules can be used anywhere conventional thermodynamic steam traps are used. This trap module can be used on either vertical or horizontal piping installations and can mount to any 2-bolt Quick-Change Universal Connector.

How It Works

The UC450 universal connector is permanently installed into the pipeline where the steam trap would normally be placed. The trap module, which functions like any thermodynamic steam trap, is fastened to the universal connector with two bolts. When a new trap module is needed, it can be easily removed and replaced with a standard open-end or socket wrench without disturbing the existing piping.

Features

- Trap module can be easily removed and replaced in minutes without having to disconnect any piping
- Trap modules can be used with most manufacturers' 2-bolt universal connector
- All stainless steel construction with hardened seat

Sample Specification

The steam trap module shall be designed to attach to the industry standard two-bolt universal connector. Trap module shall be of a thermodynamic design. Universal connector shall conform to the two bolt industry standard with integral strainer and blowdown options.

Installation and Maintenance

Universal connector is first permanently installed (threaded, welded, flanged) into piping system. Trap module should be installed in orientation shown with cap facing upwards. The trap module is fastened to the universal connector using two bolts. If the trap fails for any reason, replace only the trap module. In vertical piping installations with upward flow, use of a blowdown valve is not recommended. Discharge would be in upward and unsafe direction.

Options

Universal Connectors are available with an integral strainer and blowdown valve. Connector is purchased separately. See the Universal Connectors section for more information.

Helpful Selection Information

Connector selection to use with the UTD450SM and UTD600LSM: UC450 (no strainer), UC450SR (strainer), UC450SBR (strainer and blowdown).

MATERIALS

Body	Stainless Steel, AISI 420
Disc	Stainless Steel, AISI 420
Cap	Stainless Steel, AISI 416
Insulation Cover	Stainless Steel, AISI 304
Bolts	Steel, ASTM A193 GR B7
Gaskets (2)	Spiral Wound 304 Stainless Steel with Grafoil Filler

CAPACITIES – Condensate (lbs/hr)

Model	Differential Pressure (PSI)																
	4	10	15	20	25	30	40	50	75	100	150	200	250	300	400	450	600
UTD450LSM	140	215	242	270	295	320	355	390	455	510	600	670	730	790	880	925	
UTD450SM	247	370	420	475	520	560	625	685	800	900	1060	1185	1300	1400	1560	1630	
UTD600LSM											465	500	550	600	632	675	730

UTD450 UTD600

Universal Style Quick-Change Trap Module

Thermodynamic Steam Trap Module (mounts to UC450 Universal Connectors)

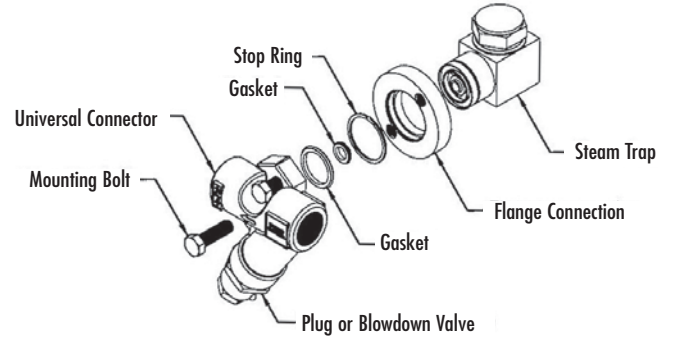

UTD450/UTD600 Trap Module should be oriented with cap facing Upwards, As shown.

Horizontal Piping (Connector with Strainer)	Vertical Piping (Connector with Strainer)	Vertical or Horizontal Piping (No Strainer)
<p>Steam Flow to the Right or to the Left</p> <p>Trap shown with UC450SBR Connector</p> <p>Trap shown with UC450SBL Connector</p>	<p>Steam Flow Downward</p> <p>Trap shown with UC450SBR Connector</p>	<p>Steam Flow Vertically or Horizontally</p> <p>Trap shown with UC450 Connector</p>

Connectors available in 1/2", 3/4" and 1" sizes in NPT and Socket-Weld Connections

UC450SR
CONNECTOR
Strainer

UC450SBR
CONNECTOR
Strainer & Blowdown

**UTD450SM
or
UTD600LSM
Steam Trap**

UC450SBL
CONNECTOR
Strainer & Blowdown

DIMENSIONS - inches			
Size	A	B	C
1/2"	3.31	3.25	3.78
3/4"	3.31	3.25	3.78
1"	3.62	3.44	3.95